

**Pulegge per cinghie dentate
passo metrico ST per cinghie «AT»
ST Timing belt pulleys metric pitch for «AT» belts
ST Zahnriemenscheiben metrische Teilung für «AT»
Poulies dentées ST
pour courroies «AT» pas métrique
Poleas dentadas ST para correas «AT» paso en mm**



Pulegge per cinghie dentate passo metrico ST per cinghie " AT "
ST Timing belt pulleys metric pitch for " AT " belts
ST Zahnriemenscheiben metrische Teilung für " AT "
Poules dentées ST pour courroies " AT " pas métrique
Poleas dentadas ST para correas " AT " paso en mm

Materiale: alluminio 6082 T6 UNI 9006/4 adatto al trattamento anodico

Material: aluminium 6082 T6 UNI 9006/4 suitable for anodic treatment

Material: aluminium 6082 T6 UNI 9006/4 geeignet für anodischen oxydation

Material: aluminium 6082 T6 UNI 9006/4 apte au traitement anodique

Material: aluminio 6082 T6 UNI 9006/4 apto para la oxidacion anodica

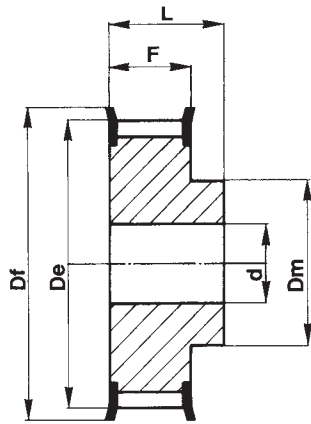

TIPO TYPE 6F

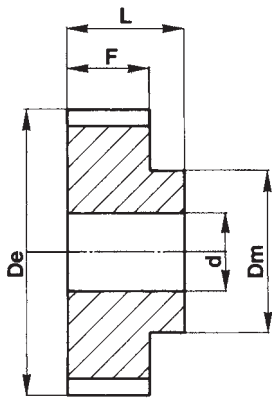

TIPO TYPE 6

(PASSO 5 mm) PER CINGHIA LARGHEZZA 10 mm - (PITCH 5 mm) FOR BELT WIDTH 10 mm
 (TEILUNG 5 mm) FUER RIEMENBREITE 10 mm - (PAS 5 mm) POUR COURROIES LARGEUR 10 mm
 (PASO 5 mm) PARA CORREAS ANCHO 10 mm

ST 5

| CODICE CODE SYMBOL FABRIKNUMMER CODE SYMBOLE NUMERO DE FABRICA | NOSTRO CODICE OUR CODE UNSER KODE NOTRE CODE NUESTRO CODIGO | TIPO TYPE TYP TYPE TIPO | TIPO FLANGIA FLANGES TYPE BORDSCHEIBEN TYP TYPE FLASQUES TIPO TAPETAS | N.DENTI N. OF TEETH ZAHNEZAHL N. BRE DE DENTS CANTIDAD DE DIENTES | De | Df | Dm | F | L | d | PESO WEIGHT GEWICHT POIDS PESO Kg |
|---|---|-------------------------------------|--|--|-------|------|----|----|----|---|--|
| 21 ST5/12-2 | 21ST512 | 6F | F07 | 12 | 17,85 | 23,0 | 11 | 15 | 21 | 4 | 0,018 |
| 21 ST5/14-2 | 21ST514 | 6F | F08 | 14 | 21,05 | 25,0 | 14 | 15 | 21 | 4 | 0,019 |
| 21 ST5/15-2 | 21ST515 | 6F | F09 | 15 | 22,65 | 28,0 | 16 | 15 | 21 | 6 | 0,021 |
| 21 ST5/16-2 | 21ST516 | 6F | F10 | 16 | 24,20 | 32,0 | 18 | 15 | 21 | 6 | 0,025 |
| 21 ST5/18-2 | 21ST518 | 6F | F10 | 18 | 27,40 | 32,0 | 20 | 15 | 21 | 6 | 0,031 |
| 21 ST5/19-2 | 21ST519 | 6F | F12 | 19 | 29,00 | 36,0 | 22 | 15 | 21 | 6 | 0,036 |
| 21 ST5/20-2 | 21ST520 | 6F | F12 | 20 | 30,60 | 36,0 | 23 | 15 | 21 | 6 | 0,038 |
| 21 ST5/22-2 | 21ST522 | 6F | F14 | 22 | 33,85 | 38,0 | 24 | 15 | 21 | 6 | 0,048 |
| 21 ST5/24-2 | 21ST524 | 6F | F15 | 24 | 37,00 | 42,0 | 26 | 15 | 21 | 6 | 0,054 |
| 21 ST5/25-2 | 21ST525 | 6F | F17 | 25 | 38,60 | 44,0 | 26 | 15 | 21 | 6 | 0,058 |
| 21 ST5/26-2 | 21ST526 | 6F | F17 | 26 | 40,20 | 44,0 | 26 | 15 | 21 | 6 | 0,062 |
| 21 ST5/27-2 | 21ST527 | 6F | F18 | 27 | 41,80 | 48,0 | 30 | 15 | 21 | 8 | 0,064 |
| 21 ST5/28-2 | 21ST528 | 6F | F18 | 28 | 43,35 | 48,0 | 32 | 15 | 21 | 8 | 0,071 |
| 21 ST5/30-2 | 21ST530 | 6F | F19 | 30 | 46,55 | 51,0 | 34 | 15 | 21 | 8 | 0,076 |
| 21 ST5/32-2 | 21ST532 | 6F | F20 | 32 | 49,70 | 54,0 | 36 | 15 | 21 | 8 | 0,088 |
| 21 ST5/36-2 | 21ST536 | 6F | F24 | 36 | 56,05 | 64,0 | 38 | 15 | 21 | 8 | 0,114 |
| 21 ST5/40-2 | 21ST540 | 6F | F25 | 40 | 62,45 | 66,0 | 40 | 15 | 21 | 8 | 0,138 |
| 21 ST5/42-2 | 21ST542 | 6F | F26 | 42 | 65,60 | 70,0 | 40 | 15 | 21 | 8 | 0,180 |
| 21 ST5/44-0 | 21ST544 | 6 | | 44 | 68,80 | - | 45 | 15 | 21 | 8 | 0,185 |
| 21 ST5/48-0 | 21ST548 | 6 | | 48 | 75,15 | - | 50 | 15 | 21 | 8 | 0,200 |
| 21 ST5/60-0 | 21ST560 | 6 | | 60 | 94,25 | - | 65 | 15 | 21 | 8 | 0,307 |

(PASSO 5 mm) PER CINGHIA LARGHEZZA 16 mm - (PITCH 5 mm) FOR BELT WIDTH 16 mm
 (TEILUNG 5 mm) FUER RIEMENBREITE 16 mm - (PAS 5 mm) POUR COURROIES LARGEUR 16 mm
 (PASO 5 mm) PARA CORREAS ANCHO 16 mm

ST 5

| CODICE CODE SYMBOL FABRIKNUMMER CODE SYMBOLE NUMERO DE FABRICA | NOSTRO CODICE OUR CODE UNSER KODE NOTRE CODE NUESTRO CODIGO | TIPO TYPE TYP TYPE TIPO | TIPO FLANGIA FLANGES TYPE BORDSCHEIBEN TYP TYPE FLASQUES TIPO TAPETAS | N.DENTI N. OF TEETH ZAHNEZAHL N. BRE DE DENTS CANTIDAD DE DIENTES | De | Df | Dm | F | L | d | PESO WEIGHT GEWICHT POIDS PESO Kg |
|---|---|-------------------------------------|--|--|-------|------|----|----|----|---|--|
| 27 ST5/12-2 | 27ST512 | 6F | F07 | 12 | 17,85 | 23,0 | 11 | 21 | 27 | 4 | 0,022 |
| 27 ST5/14-2 | 27ST514 | 6F | F08 | 14 | 21,05 | 25,0 | 14 | 21 | 27 | 4 | 0,026 |
| 27 ST5/15-2 | 27ST515 | 6F | F09 | 15 | 22,65 | 28,0 | 16 | 21 | 27 | 6 | 0,029 |
| 27 ST5/16-2 | 27ST516 | 6F | F10 | 16 | 24,20 | 32,0 | 18 | 21 | 27 | 6 | 0,035 |
| 27 ST5/18-2 | 27ST518 | 6F | F10 | 18 | 27,40 | 32,0 | 20 | 21 | 27 | 6 | 0,043 |
| 27 ST5/19-2 | 27ST519 | 6F | F12 | 19 | 29,00 | 36,0 | 22 | 21 | 27 | 6 | 0,049 |
| 27 ST5/20-2 | 27ST520 | 6F | F12 | 20 | 30,60 | 36,0 | 23 | 21 | 27 | 6 | 0,053 |
| 27 ST5/22-2 | 27ST522 | 6F | F14 | 22 | 33,85 | 38,0 | 24 | 21 | 27 | 6 | 0,054 |
| 27 ST5/24-2 | 27ST524 | 6F | F15 | 24 | 37,00 | 42,0 | 26 | 21 | 27 | 6 | 0,076 |
| 27 ST5/25-2 | 27ST525 | 6F | F17 | 25 | 38,60 | 44,0 | 26 | 21 | 27 | 6 | 0,081 |
| 27 ST5/26-2 | 27ST526 | 6F | F17 | 26 | 40,20 | 44,0 | 26 | 21 | 27 | 6 | 0,085 |
| 27 ST5/27-2 | 27ST527 | 6F | F18 | 27 | 41,80 | 48,0 | 30 | 21 | 27 | 8 | 0,090 |
| 27 ST5/28-2 | 27ST528 | 6F | F18 | 28 | 43,35 | 48,0 | 32 | 21 | 27 | 8 | 0,092 |
| 27 ST5/30-2 | 27ST530 | 6F | F19 | 30 | 46,55 | 51,0 | 34 | 21 | 27 | 8 | 0,105 |
| 27 ST5/32-2 | 27ST532 | 6F | F20 | 32 | 49,70 | 54,0 | 36 | 21 | 27 | 8 | 0,123 |
| 27 ST5/36-2 | 27ST536 | 6F | F24 | 36 | 56,05 | 64,0 | 38 | 21 | 27 | 8 | 0,160 |
| 27 ST5/40-2 | 27ST540 | 6F | F25 | 40 | 62,45 | 66,0 | 40 | 21 | 27 | 8 | 0,193 |
| 27 ST5/42-2 | 27ST542 | 6F | F26 | 42 | 65,60 | 70,0 | 40 | 21 | 27 | 8 | 0,205 |
| 27 ST5/44-0 | 27ST544 | 6 | | 44 | 68,80 | - | 45 | 21 | 27 | 8 | 0,228 |
| 27 ST5/48-0 | 27ST548 | 6 | | 48 | 75,15 | - | 50 | 21 | 27 | 8 | 0,280 |
| 27 ST5/60-0 | 27ST560 | 6 | | 60 | 94,25 | - | 65 | 21 | 27 | 8 | 0,430 |

(PASSO 5 mm) PER CINGHIA LARGHEZZA 25 mm - (PITCH 5 mm) FOR BELT WIDTH 25 mm
 (TEILUNG 5 mm) FUER RIEMENBREITE 25 mm - (PAS 5 mm) POUR COURROIES LARGEUR 25 mm
 (PASO 5 mm) PARA CORREAS ANCHO 25 mm

ST 5

| CODICE CODE SYMBOL FABRIKNUMMER CODE SYMBOLE NUMERO DE FABRICA | NOSTRO CODICE OUR CODE UNSER KODE NOTRE CODE NUESTRO CODIGO | TIPO TYPE TYP TYPE TIPO | TIPO FLANGIA FLANGES TYPE BORDSCHEIBEN TYP TYPE FLASQUES TIPO TAPETAS | N.DENTI N. OF TEETH ZAHNEZAHL N. BRE DE DENTS CANTIDAD DE DIENTES | De | Df | Dm | F | L | d | PESO WEIGHT GEWICHT POIDS PESO Kg |
|---|---|-------------------------------------|--|--|-------|------|----|----|----|---|--|
| 36 ST5/12-2 | 36ST512 | 6F | F07 | 12 | 17,85 | 23,0 | 11 | 30 | 36 | 4 | 0,031 |
| 36 ST5/14-2 | 36ST514 | 6F | F08 | 14 | 21,05 | 25,0 | 14 | 30 | 36 | 4 | 0,037 |
| 36 ST5/15-2 | 36ST515 | 6F | F09 | 15 | 22,65 | 28,0 | 16 | 30 | 36 | 6 | 0,041 |
| 36 ST5/16-2 | 36ST516 | 6F | F10 | 16 | 24,20 | 32,0 | 18 | 30 | 36 | 6 | 0,050 |
| 36 ST5/18-2 | 36ST518 | 6F | F10 | 18 | 27,40 | 32,0 | 20 | 30 | 36 | 6 | 0,061 |
| 36 ST5/19-2 | 36ST519 | 6F | F12 | 19 | 29,00 | 36,0 | 22 | 30 | 36 | 6 | 0,070 |
| 36 ST5/20-2 | 36ST520 | 6F | F12 | 20 | 30,60 | 36,0 | 23 | 30 | 36 | 6 | 0,076 |
| 36 ST5/22-2 | 36ST522 | 6F | F14 | 22 | 33,85 | 38,0 | 24 | 30 | 36 | 6 | 0,080 |
| 36 ST5/24-2 | 36ST524 | 6F | F15 | 24 | 37,00 | 42,0 | 26 | 30 | 36 | 6 | 0,109 |
| 36 ST5/25-2 | 36ST525 | 6F | F17 | 25 | 38,60 | 44,0 | 26 | 30 | 36 | 6 | 0,118 |
| 36 ST5/26-2 | 36ST526 | 6F | F17 | 26 | 40,20 | 44,0 | 26 | 30 | 36 | 6 | 0,120 |
| 36 ST5/27-2 | 36ST527 | 6F | F18 | 27 | 41,80 | 48,0 | 30 | 30 | 36 | 8 | 0,128 |
| 36 ST5/28-2 | 36ST528 | 6F | F18 | 28 | 43,35 | 48,0 | 32 | 30 | 36 | 8 | 0,135 |
| 36 ST5/30-2 | 36ST530 | 6F | F19 | 30 | 46,55 | 51,0 | 34 | 30 | 36 | 8 | 0,150 |
| 36 ST5/32-2 | 36ST532 | 6F | F20 | 32 | 49,70 | 54,0 | 36 | 30 | 36 | 8 | 0,178 |
| 36 ST5/36-2 | 36ST536 | 6F | F24 | 36 | 56,05 | 64,0 | 38 | 30 | 36 | 8 | 0,230 |
| 36 ST5/40-2 | 36ST540 | 6F | F25 | 40 | 62,45 | 66,0 | 40 | 30 | 36 | 8 | 0,278 |
| 36 ST5/42-2 | 36ST542 | 6F | F26 | 42 | 65,60 | 70,0 | 40 | 30 | 36 | 8 | 0,284 |
| 36 ST5/44-0 | 36ST544 | 6 | | 44 | 68,80 | - | 45 | 30 | 36 | 8 | 0,315 |
| 36 ST5/48-0 | 36ST548 | 6 | | 48 | 75,15 | - | 50 | 30 | 36 | 8 | 0,400 |
| 36 ST5/60-0 | 36ST560 | 6 | | 60 | 94,25 | - | 65 | 30 | 36 | 8 | 0,614 |

Pulegge per cinghie dentate passo metrico ST per cinghie " AT "
ST Timing belt pulleys metric pitch for " AT " belts
ST Zahnriemenscheiben metrische Teilung für " AT "
Poulies dentées ST pour courroies " AT " pas métrique
Poleas dentadas ST para correas " AT " paso en mm



Materiale: alluminio 6082 T6 UNI 9006/4 adatto al trattamento anodico

Material: aluminium 6082 T6 UNI 9006/4 suitable for anodic treatment

Material: aluminium 6082 T6 UNI 9006/4 geeignet für anodischen oxydation

Material: aluminium 6082 T6 UNI 9006/4 apte au traitement anodique

Material: aluminio 6082 T6 UNI 9006/4 apto para la oxidacion anodica

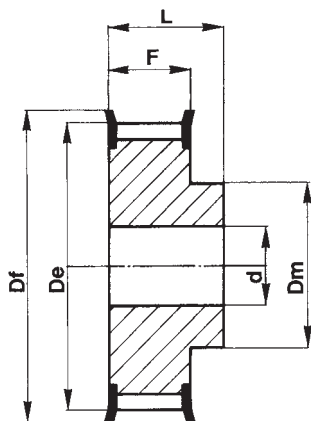

TIPO TYPE 6F

(PASSO 10 mm) PER CINGHIA LARGHEZZA 16 mm - (PITCH 10 mm) FOR BELT WIDTH 16 mm
 (TEILUNG 10 mm) FUER RIEMENBREITE 16 mm - (PAS 10 mm) POUR COURROIES LARGEUR 16 mm
 (PASO 10 mm) PARA CORREAS ANCHO 16 mm

ST 10

| CODICE CODE SYMBOL FABRIKNUMMER CODE SYMBOLE NUMERO DE FABRICA | NOSTRO CODICE OUR CODE UNSER KODE NOTRE CODE NUESTRO CODIGO | TIPO TYPE TYP TYPE TIPO | TIPO FLANGIA FLANGES TYPE BORDSCEIBEN TYP TYPE FLASQUES TIPO TAPETAS | N.DENTI N. OF TEETH ZAHNEZAHL N. BRE DE DENTS CANTIDAD DE DIENTES | De | Df | Dm | F | L | d | PESO WEIGHT GEWICHT POIDS PESO Kg |
|---|---|-------------------------------------|---|--|--------|-----|-----|----|----|----|--|
| 31 ST10/15-2 | 31ST115 | 6F | F19 | 15 | 45,90 | 51 | 31 | 21 | 31 | 8 | 0,118 |
| 31 ST10/16-2 | 31ST116 | 6F | F20 | 16 | 49,05 | 54 | 35 | 21 | 31 | 8 | 0,134 |
| 31 ST10/18-2 | 31ST118 | 6F | F22 | 18 | 55,45 | 60 | 40 | 21 | 31 | 8 | 0,167 |
| 31 ST10/19-2 | 31ST119 | 6F | F25 | 19 | 58,60 | 66 | 44 | 21 | 31 | 8 | 0,184 |
| 31 ST10/20-2 | 31ST120 | 6F | F25 | 20 | 61,80 | 66 | 46 | 21 | 31 | 8 | 0,208 |
| 31 ST10/22-2 | 31ST122 | 6F | F27 | 22 | 68,15 | 75 | 52 | 21 | 31 | 8 | 0,253 |
| 31 ST10/24-2 | 31ST124 | 6F | F29 | 24 | 74,55 | 83 | 58 | 21 | 31 | 8 | 0,288 |
| 31 ST10/25-2 | 31ST125 | 6F | F29 | 25 | 77,70 | 83 | 60 | 21 | 31 | 8 | 0,310 |
| 31 ST10/26-2 | 31ST126 | 6F | F30 | 26 | 80,90 | 87 | 60 | 21 | 31 | 8 | 0,357 |
| 31 ST10/27-2 | 31ST127 | 6F | F31 | 27 | 84,10 | 91 | 60 | 21 | 31 | 8 | 0,364 |
| 31 ST10/28-2 | 31ST128 | 6F | F32 | 28 | 87,25 | 93 | 60 | 21 | 31 | 8 | 0,401 |
| 31 ST10/30-2 | 31ST130 | 6F | F33 | 30 | 93,65 | 97 | 60 | 21 | 31 | 8 | 0,441 |
| 31 ST10/32-2 | 31ST132 | 6F | F35 | 32 | 100,00 | 106 | 65 | 21 | 31 | 10 | 0,493 |
| 31 ST10/36-2 | 31ST136 | 6F | F38 | 36 | 112,75 | 120 | 70 | 21 | 31 | 10 | 0,623 |
| 31 ST10/40-2 | 31ST140 | 6F | F42 | 40 | 125,45 | 135 | 80 | 21 | 31 | 10 | 0,787 |
| 31 ST10/44-0 | 31ST144 | 6 | | 44 | 138,20 | - | 88 | 21 | 31 | 10 | 0,993 |
| 31 ST10/48-0 | 31ST148 | 6 | | 48 | 150,95 | - | 95 | 21 | 31 | 16 | 1,090 |
| 31 ST10/60-0 | 31ST160 | 6 | | 60 | 189,10 | - | 110 | 21 | 31 | 16 | 1,701 |

(PASSO 10 mm) PER CINGHIA LARGHEZZA 25 mm - (PITCH 10 mm) FOR BELT WIDTH 25 mm
 (TEILUNG 10 mm) FUER RIEMENBREITE 25 mm - (PAS 10 mm) POUR COURROIES LARGEUR 25 mm
 (PASO 10 mm) PARA CORREAS ANCHO 25 mm

ST 10

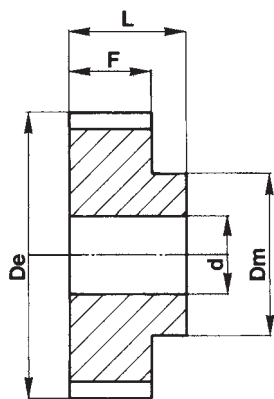

TIPO TYPE 6

| CODICE CODE SYMBOL FABRIKNUMMER CODE SYMBOLE NUMERO DE FABRICA | NOSTRO CODICE OUR CODE UNSER KODE NOTRE CODE NUESTRO CODIGO | TIPO TYPE TYP TYPE TIPO | TIPO FLANGIA FLANGES TYPE BORDSCEIBEN TYP TYPE FLASQUES TIPO TAPETAS | N.DENTI N. OF TEETH ZAHNEZAHL N. BRE DE DENTS CANTIDAD DE DIENTES | De | Df | Dm | F | L | d | PESO WEIGHT GEWICHT POIDS PESO Kg |
|---|---|-------------------------------------|---|--|--------|-----|-----|----|----|----|--|
| 40 ST10/15-2 | 40ST115 | 6F | F19 | 15 | 45,90 | 51 | 32 | 30 | 40 | 8 | 0,152 |
| 40 ST10/16-2 | 40ST116 | 6F | F20 | 16 | 49,05 | 54 | 35 | 30 | 40 | 8 | 0,176 |
| 40 ST10/18-2 | 40ST118 | 6F | F22 | 18 | 55,45 | 60 | 40 | 30 | 40 | 8 | 0,224 |
| 40 ST10/19-2 | 40ST119 | 6F | F25 | 19 | 58,60 | 66 | 44 | 30 | 40 | 8 | 0,247 |
| 40 ST10/20-2 | 40ST120 | 6F | F25 | 20 | 61,80 | 66 | 46 | 30 | 40 | 8 | 0,276 |
| 40 ST10/22-2 | 40ST122 | 6F | F27 | 22 | 68,15 | 75 | 52 | 30 | 40 | 8 | 0,337 |
| 40 ST10/24-2 | 40ST124 | 6F | F29 | 24 | 74,55 | 83 | 58 | 30 | 40 | 8 | 0,392 |
| 40 ST10/25-2 | 40ST125 | 6F | F29 | 25 | 77,70 | 83 | 60 | 30 | 40 | 8 | 0,422 |
| 40 ST10/26-2 | 40ST126 | 6F | F30 | 26 | 80,90 | 87 | 60 | 30 | 40 | 8 | 0,477 |
| 40 ST10/27-2 | 40ST127 | 6F | F31 | 27 | 84,10 | 91 | 60 | 30 | 40 | 8 | 0,536 |
| 40 ST10/28-2 | 40ST128 | 6F | F32 | 28 | 87,25 | 93 | 60 | 30 | 40 | 8 | 0,540 |
| 40 ST10/30-2 | 40ST130 | 6F | F33 | 30 | 93,65 | 97 | 60 | 30 | 40 | 8 | 0,640 |
| 40 ST10/32-2 | 40ST132 | 6F | F35 | 32 | 100,00 | 106 | 65 | 30 | 40 | 10 | 0,693 |
| 40 ST10/36-2 | 40ST136 | 6F | F38 | 36 | 112,75 | 120 | 70 | 30 | 40 | 10 | 0,873 |
| 40 ST10/40-2 | 40ST140 | 6F | F42 | 40 | 125,45 | 135 | 80 | 30 | 40 | 10 | 1,067 |
| 40 ST10/44-0 | 40ST144 | 6 | | 44 | 138,20 | - | 88 | 30 | 40 | 10 | 1,350 |
| 40 ST10/48-0 | 40ST148 | 6 | | 48 | 150,95 | - | 95 | 30 | 40 | 16 | 1,516 |
| 40 ST10/60-0 | 40ST160 | 6 | | 60 | 189,10 | - | 110 | 30 | 40 | 16 | 2,339 |

Pulegge per cinghie dentate passo metrico ST per cinghie " AT "
ST Timing belt pulleys metric pitch for " AT " belts
ST Zahnriemenscheiben metrische Teilung für " AT "
Poules dentées ST pour courroies " AT " pas métrique
Poleas dentadas ST para correas " AT " paso en mm

Materiale: alluminio 6082 T6 UNI 9006/4 adatto al trattamento anodico

Material: aluminium 6082 T6 UNI 9006/4 suitable for anodic treatment

Material: aluminium 6082 T6 UNI 9006/4 geeignet für anodischen oxydation

Material: aluminium 6082 T6 UNI 9006/4 apte au traitement anodique

Material: aluminio 6082 T6 UNI 9006/4 apto para la oxidacion anodica

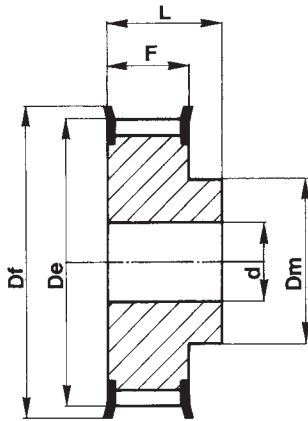

TIPO TYPE 6F

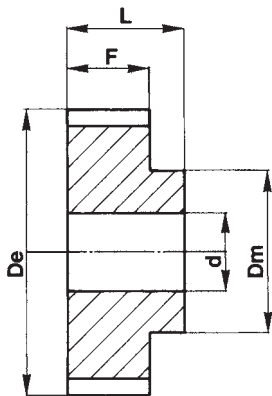

TIPO TYPE 6

(PASSO 10 mm) PER CINGHIA LARGHEZZA 32 mm - (PITCH 10 mm) FOR BELT WIDTH 32 mm
 (TEILUNG 10 mm) FUER RIEMENBREITE 32 mm - (PAS 10 mm) POUR COURROIES LARGEUR 32 mm
 (PASO 10 mm) PARA CORREAS ANCHO 32 mm

ST 10

| CODICE CODE SYMBOL FABRIKNUMMER CODE SYMBOLE NUMERO DE FABRICA | NOSTRO CODICE OUR CODE UNSER KODE NOTRE CODE NUESTRO CODIGO | TIPO TYPE TYP TYPE TIPO | TIPO FLANGIA FLANGES TYPE BORDSCHEIBEN TYP TYPE FLASQUES TIPO TAPETAS | N.DENTI N. OF TEETH ZAHNEZAHL N. BRE DE DENTS CANTIDAD DE DIENTES | De | Df | Dm | F | L | d | PESO WEIGHT GEWICHT POIDS PESO Kg |
|---|---|-------------------------------------|--|--|--------|-----|-----|----|----|----|--|
| 47 ST10/18-2 | 47ST118 | 6F | F22 | 18 | 55,45 | 60 | 40 | 37 | 47 | 10 | 0,253 |
| 47 ST10/19-2 | 47ST119 | 6F | F25 | 19 | 58,60 | 66 | 44 | 37 | 47 | 10 | 0,286 |
| 47 ST10/20-2 | 47ST120 | 6F | F25 | 20 | 61,80 | 66 | 46 | 37 | 47 | 12 | 0,322 |
| 47 ST10/22-2 | 47ST122 | 6F | F27 | 22 | 68,15 | 75 | 52 | 37 | 47 | 12 | 0,393 |
| 47 ST10/24-2 | 47ST124 | 6F | F29 | 24 | 74,55 | 83 | 58 | 37 | 47 | 12 | 0,475 |
| 47 ST10/25-2 | 47ST125 | 6F | F29 | 25 | 77,70 | 83 | 60 | 37 | 47 | 12 | 0,527 |
| 47 ST10/26-2 | 47ST126 | 6F | F30 | 26 | 80,90 | 87 | 60 | 37 | 47 | 12 | 0,564 |
| 47 ST10/27-2 | 47ST127 | 6F | F31 | 27 | 84,10 | 91 | 60 | 37 | 47 | 12 | 0,602 |
| 47 ST10/28-2 | 47ST128 | 6F | F32 | 28 | 87,25 | 93 | 60 | 37 | 47 | 12 | 0,642 |
| 47 ST10/30-2 | 47ST130 | 6F | F33 | 30 | 93,65 | 97 | 60 | 37 | 47 | 12 | 0,740 |
| 47 ST10/32-2 | 47ST132 | 6F | F35 | 32 | 100,00 | 106 | 65 | 37 | 47 | 12 | 0,844 |
| 47 ST10/36-2 | 47ST136 | 6F | F38 | 36 | 112,75 | 120 | 70 | 37 | 47 | 16 | 1,063 |
| 47 ST10/40-2 | 47ST140 | 6F | F42 | 40 | 125,45 | 135 | 80 | 37 | 47 | 16 | 1,317 |
| 47 ST10/44-0 | 47ST144 | 6 | | 44 | 138,20 | - | 88 | 37 | 47 | 16 | 1,611 |
| 47 ST10/48-0 | 47ST148 | 6 | | 48 | 150,95 | - | 95 | 37 | 47 | 16 | 1,931 |
| 47 ST10/60-0 | 47ST160 | 6 | | 60 | 189,10 | - | 110 | 37 | 47 | 16 | 3,004 |

(PASSO 10 mm) PER CINGHIA LARGHEZZA 50 mm - (PITCH 10 mm) FOR BELT WIDTH 50 mm
 (TEILUNG 10 mm) FUER RIEMENBREITE 50 mm - (PAS 10 mm) POUR COURROIES LARGEUR 50 mm
 (PASO 10 mm) PARA CORREAS ANCHO 50 mm

ST 10

| CODICE CODE SYMBOL FABRIKNUMMER CODE SYMBOLE NUMERO DE FABRICA | NOSTRO CODICE OUR CODE UNSER KODE NOTRE CODE NUESTRO CODIGO | TIPO TYPE TYP TYPE TIPO | TIPO FLANGIA FLANGES TYPE BORDSCHEIBEN TYP TYPE FLASQUES TIPO TAPETAS | N.DENTI N. OF TEETH ZAHNEZAHL N. BRE DE DENTS CANTIDAD DE DIENTES | De | Df | Dm | F | L | d | PESO WEIGHT GEWICHT POIDS PESO Kg |
|---|---|-------------------------------------|--|--|--------|-----|-----|----|----|----|--|
| 66 ST10/18-2 | 66ST118 | 6F | F22 | 18 | 55,45 | 60 | 40 | 56 | 66 | 10 | 0,422 |
| 66 ST10/19-2 | 66ST119 | 6F | F25 | 19 | 58,60 | 66 | 44 | 56 | 66 | 10 | 0,466 |
| 66 ST10/20-2 | 66ST120 | 6F | F25 | 20 | 61,80 | 66 | 46 | 56 | 66 | 12 | 0,520 |
| 66 ST10/22-2 | 66ST122 | 6F | F27 | 22 | 68,15 | 75 | 52 | 56 | 66 | 12 | 0,570 |
| 66 ST10/24-2 | 66ST124 | 6F | F29 | 24 | 74,55 | 83 | 58 | 56 | 66 | 12 | 0,736 |
| 66 ST10/25-2 | 66ST125 | 6F | F29 | 25 | 77,70 | 83 | 60 | 56 | 66 | 12 | 0,766 |
| 66 ST10/26-2 | 66ST126 | 6F | F30 | 26 | 80,90 | 87 | 60 | 56 | 66 | 12 | 0,816 |
| 66 ST10/27-2 | 66ST127 | 6F | F31 | 27 | 84,10 | 91 | 60 | 56 | 66 | 12 | 0,946 |
| 66 ST10/28-2 | 66ST128 | 6F | F32 | 28 | 87,25 | 93 | 60 | 56 | 66 | 12 | 0,960 |
| 66 ST10/30-2 | 66ST130 | 6F | F33 | 30 | 93,65 | 97 | 60 | 56 | 66 | 12 | 1,169 |
| 66 ST10/32-2 | 66ST132 | 6F | F35 | 32 | 100,00 | 106 | 65 | 56 | 66 | 12 | 1,300 |
| 66 ST10/36-2 | 66ST136 | 6F | F38 | 36 | 112,75 | 120 | 70 | 56 | 66 | 16 | 1,637 |
| 66 ST10/40-2 | 66ST140 | 6F | F42 | 40 | 125,45 | 135 | 80 | 56 | 66 | 16 | 1,999 |
| 66 ST10/44-0 | 66ST144 | 6 | | 44 | 138,20 | - | 88 | 56 | 66 | 16 | 2,357 |
| 66 ST10/48-0 | 66ST148 | 6 | | 48 | 150,95 | - | 95 | 56 | 66 | 16 | 2,830 |
| 66 ST10/60-0 | 66ST160 | 6 | | 60 | 189,10 | - | 110 | 56 | 66 | 16 | 4,368 |

Barre dentate standard ST per cinghie " AT "
ST Standard toothed bars for " AT " belts
ST Standard Zahnriemenstangen für " AT"
Barreaux dentés standard ST pour courroies " AT"
Barras dentadas de serie ST para correas " AT "

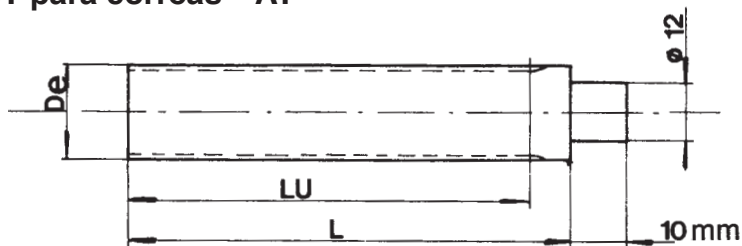

Materiale: alluminio 6082 T6 UNI 9006/4 adatto al trattamento anodico
Material: aluminium 6082 T6 UNI 9006/4 suitable for anodic treatment
Material: aluminium 6082 T6 UNI 9006/4 geeignet für anodischen oxydation
Material: aluminium 6082 T6 UNI 9006/4 apte au traitement anodique
Material: aluminio 6082 T6 UNI 9006/4 apto para la oxidacion anodica

ST 5
(PASSO 5 mm)
(PITCH 5 mm)
(TEILUNG 5 mm)
(PAS 5 mm)
(PASO 5 mm)

| CODICE CODE SYMBOL FABRIKNUMMER CODE SYMBOLE NUMERO DE FABRICA | NOSTRO CODICE OUR CODE UNSER KODE NOTRE CODE NUESTRO CODIGO | N.DENTI N. OF TEETH ZAHNEZAHL N. BRE DE DENTS CANTIDAD DE DIENTES | De | Lu | L |
|---|---|---|--------|-----|-----|
| ST05012 | BST0512 | 12 | 17,85 | 125 | 140 |
| ST05013 | BST0513 | 13 | 19,45 | 125 | 140 |
| ST05014 | BST0514 | 14 | 21,05 | 132 | 140 |
| ST05015 | BST0515 | 15 | 22,65 | 132 | 140 |
| ST05016 | BST0516 | 16 | 24,20 | 140 | 140 |
| ST05017 | BST0517 | 17 | 25,80 | 140 | 140 |
| ST05018 | BST0518 | 18 | 27,40 | 140 | 140 |
| ST05019 | BST0519 | 19 | 29,00 | 140 | 140 |
| ST05020 | BST0520 | 20 | 30,60 | 160 | 160 |
| ST05021 | BST0521 | 21 | 32,30 | 160 | 160 |
| ST05022 | BST0522 | 22 | 33,85 | 160 | 160 |
| ST05023 | BST0523 | 23 | 35,45 | 160 | 160 |
| ST05024 | BST0524 | 24 | 37,00 | 160 | 160 |
| ST05025 | BST0525 | 25 | 38,60 | 160 | 160 |
| ST05026 | BST0526 | 26 | 40,20 | 160 | 160 |
| ST05027 | BST0527 | 27 | 41,80 | 160 | 160 |
| ST05028 | BST0528 | 28 | 43,35 | 160 | 160 |
| ST05029 | BST0529 | 29 | 44,95 | 160 | 160 |
| ST05030 | BST0530 | 30 | 46,55 | 160 | 160 |
| ST05031 | BST0531 | 31 | 48,15 | 160 | 160 |
| ST05032 | BST0532 | 32 | 49,70 | 160 | 160 |
| ST05033 | BST0533 | 33 | 51,30 | 160 | 160 |
| ST05034 | BST0534 | 34 | 52,85 | 160 | 160 |
| ST05035 | BST0535 | 35 | 54,45 | 160 | 160 |
| ST05036 | BST0536 | 36 | 56,05 | 160 | 160 |
| ST05038 | BST0538 | 38 | 59,25 | 160 | 160 |
| ST05040 | BST0540 | 40 | 62,45 | 160 | 160 |
| ST05042 | BST0542 | 42 | 65,60 | 160 | 160 |
| ST05044 | BST0544 | 44 | 68,80 | 160 | 160 |
| ST05045 | BST0545 | 45 | 70,40 | 160 | 160 |
| ST05046 | BST0546 | 46 | 72,00 | 160 | 160 |
| ST05048 | BST0548 | 48 | 75,15 | 160 | 160 |
| ST05050 | BST0550 | 50 | 78,35 | 160 | 160 |
| ST05052 | BST0552 | 52 | 81,55 | 160 | 160 |
| ST05054 | BST0554 | 54 | 84,70 | 160 | 160 |
| ST05055 | BST0555 | 55 | 86,30 | 160 | 160 |
| ST05056 | BST0556 | 56 | 87,90 | 160 | 160 |
| ST05058 | BST0558 | 58 | 91,10 | 160 | 160 |
| ST05060 | BST0560 | 60 | 94,25 | 160 | 160 |
| ST05062 | BST0562 | 62 | 97,45 | 160 | 160 |
| ST05064 | BST0564 | 64 | 100,65 | 160 | 160 |
| ST05065 | BST0565 | 65 | 102,25 | 160 | 160 |
| ST05070 | BST0570 | 70 | 110,20 | 160 | 160 |
| ST05072 | BST0572 | 72 | 113,25 | 160 | 160 |

ST 10
(PASSO 10 mm)
(PITCH 10 mm)
(TEILUNG 10 mm)
(PAS 10 mm)
(PASO 10 mm)

| CODICE CODE SYMBOL FABRIKNUMMER CODE SYMBOLE NUMERO DE FABRICA | NOSTRO CODICE OUR CODE UNSER KODE NOTRE CODE NUESTRO CODIGO | N.DENTI N. OF TEETH ZAHNEZAHL N. BRE DE DENTS CANTIDAD DE DIENTES | De | Lu | L |
|---|---|---|--------|-----|-----|
| ST10015 | BST1015 | 15 | 45,90 | 160 | 160 |
| ST10016 | BST1016 | 16 | 49,05 | 160 | 160 |
| ST10017 | BST1017 | 17 | 52,25 | 160 | 160 |
| ST10018 | BST1018 | 18 | 55,45 | 160 | 160 |
| ST10019 | BST1019 | 19 | 58,60 | 160 | 160 |
| ST10020 | BST1020 | 20 | 61,80 | 160 | 160 |
| ST10021 | BST1021 | 21 | 65,00 | 160 | 160 |
| ST10022 | BST1022 | 22 | 68,15 | 160 | 160 |
| ST10023 | BST1023 | 23 | 71,35 | 160 | 160 |
| ST10024 | BST1024 | 24 | 74,55 | 160 | 160 |
| ST10025 | BST1025 | 25 | 77,70 | 160 | 160 |
| ST10026 | BST1026 | 26 | 80,90 | 160 | 160 |
| ST10027 | BST1027 | 27 | 84,10 | 160 | 160 |
| ST10028 | BST1028 | 28 | 87,25 | 160 | 160 |
| ST10029 | BST1029 | 29 | 90,45 | 160 | 160 |
| ST10030 | BST1030 | 30 | 93,65 | 160 | 160 |
| ST10031 | BST1031 | 31 | 96,80 | 160 | 160 |
| ST10032 | BST1032 | 32 | 100,00 | 160 | 160 |
| ST10033 | BST1033 | 33 | 103,20 | 160 | 160 |
| ST10034 | BST1034 | 34 | 106,40 | 160 | 160 |
| ST10035 | BST1035 | 35 | 109,55 | 160 | 160 |
| ST10036 | BST1036 | 36 | 112,75 | 160 | 160 |
| ST10037 | BST1037 | 37 | 115,90 | 160 | 160 |
| ST10038 | BST1038 | 38 | 119,10 | 160 | 160 |
| ST10040 | BST1040 | 40 | 125,45 | 160 | 160 |
| ST10041 | BST1041 | 41 | 128,65 | 160 | 160 |
| ST10042 | BST1042 | 42 | 131,85 | 160 | 160 |
| ST10044 | BST1044 | 44 | 138,20 | 160 | 160 |
| ST10045 | BST1045 | 45 | 141,40 | 160 | 160 |
| ST48046 | BST1046 | 46 | 144,55 | 160 | 160 |
| ST10048 | BST1048 | 48 | 150,95 | 160 | 160 |
| ST10050 | BST1050 | 50 | 157,30 | 160 | 160 |
| ST10051 | BST1051 | 51 | 160,50 | 160 | 160 |
| ST10052 | BST1052 | 52 | 163,65 | 160 | 160 |
| ST10054 | BST1054 | 54 | 170,05 | 160 | 160 |
| ST10055 | BST1055 | 55 | 173,20 | 160 | 160 |
| ST10056 | BST1056 | 56 | 176,40 | 160 | 160 |
| ST10057 | BST1057 | 57 | 179,60 | 160 | 160 |
| ST10058 | BST1058 | 58 | 182,75 | 160 | 160 |
| ST10059 | BST1059 | 59 | 185,95 | 160 | 160 |
| ST10060 | BST1060 | 60 | 189,10 | 160 | 160 |
| ST10062 | BST1062 | 62 | 195,50 | 160 | 160 |
| ST10070 | BST1070 | 70 | 220,95 | 160 | 160 |
| ST10075 | BST1075 | 75 | 236,90 | 160 | 160 |



| N. DENTI N. OF TEETH ZÄHNEZAHL NOMBRE DE DENTS CANTIDAD DE DIENTES | FLANGIA - FLANGES - BORDSCHEIBEN - FLASQUES - TAPETAS | | TIPO FLANGIA FLANGES TYPE BORDSCHEIBEN TYP TYPE FLASQUES TIPO TAPETAS | | | |
|---|---|----------|---|------|-------|-------|
| | d = 1 mm | d = 1 mm | | | | |
| | AT 5 | AT 10 | | | | |
| 8 | - | - | F 01 | 13 | 10 | 6 |
| 9 | - | - | F 02 | 15 | 12 | 8 |
| 10 | - | - | F 03 | 16 | 13 | 9,5 |
| 11 | - | - | F 04 | 17,5 | 14,5 | 11,6 |
| 12 | F 07 | - | F 05 | 18 | 15 | 11,5 |
| 13 | - | - | F 06 | 20 | 16,5 | 12,2 |
| 14 | F 08 | - | F 07 | 23 | 18 | 12,5 |
| 15 | F 09 | F 19 | F 08 | 25 | 21,5 | 15 |
| 16 | F 10 | F 20 | F 09 | 28 | 24 | 17,8 |
| 17 | - | - | F 10 | 32 | 27,5 | 23 |
| 18 | F 10 | F 22 | F 11 | 35 | 30,5 | 23 |
| 19 | F 12 | F 25 | F 12 | 36 | 31 | 25 |
| 20 | F 12 | F 25 | F 13 | 37 | 33 | 25 |
| 21 | - | - | F 14 | 38 | 34 | 26,5 |
| 22 | F 14 | F 27 | F 15 | 42 | 38 | 30,5 |
| 23 | - | - | F 16 | 43 | 39 | 31 |
| 24 | F 15 | F 29 | F 17 | 44 | 40,5 | 32,5 |
| 25 | F 17 | F 29 | F 18 | 48 | 43,5 | 37 |
| 26 | F 17 | F 30 | F 19 | 51 | 47 | 40 |
| 27 | F 18 | F 31 | F 20 | 54 | 50,5 | 43 |
| 28 | F 18 | F 32 | F 21 | 57 | 52 | 46 |
| 29 | - | - | F 22 | 60 | 57 | 47 |
| 30 | F 19 | F 33 | F 23 | 61 | 56,5 | 49 |
| 31 | - | - | F 24 | 64 | 57 | 47 |
| 32 | F 20 | F 35 | F 25 | 66 | 63 | 52 |
| 33 | - | - | F 26 | 70 | 66,5 | 53 |
| 34 | - | - | F 27 | 75 | 68,5 | 60 |
| 35 | - | - | F 28 | 79 | 72,5 | 60 |
| 36 | F 24 | F 38 | F 29 | 83 | 78 | 68 |
| 37 | - | - | F 30 | 87 | 82,5 | 72 |
| 38 | - | - | F 31 | 91 | 85,5 | 76 |
| 39 | - | - | F 32 | 93 | 89 | 80 |
| 40 | F 25 | F 42 | F 33 | 97 | 93,8 | 83 |
| 41 | - | - | F 34 | 102 | 97 | 82,5 |
| 42 | F 26 | - | F 35 | 106 | 101 | 90 |
| 43 | - | - | F 36 | 112 | 105,5 | 91 |
| 44 | - | - | F 37 | 115 | 109 | 94 |
| 45 | - | - | F 38 | 120 | 112,5 | 99,5 |
| 46 | - | - | F 39 | 123 | 117,5 | 107 |
| 47 | - | - | F 40 | 128 | 124 | 107 |
| 48 | - | - | F 41 | 131 | 125,5 | 115 |
| 49 | - | - | F 42 | 135 | 128,5 | 115 |
| 50 | - | - | F 43 | 138 | 132 | 121 |
| 51 | - | - | F 44 | 140 | 125 | 107 |
| 52 | - | - | F 45 | 142 | 137 | 120 |
| 53 | - | - | F 46 | 146 | 133 | 107 |
| 54 | - | - | F 47 | 148 | 143 | 132 |
| 55 | - | - | F 48 | 150 | 145 | 130 |
| 56 | - | - | F 49 | 154 | 142 | 122 |
| 57 | - | - | F 50 | 158 | 153 | 138,5 |
| 58 | - | - | F 51 | 160 | 148 | 120 |
| 59 | - | - | F 52 | 168 | 161 | 148 |
| 60 | - | - | F 53 | 175 | 170 | 157 |
| 61 | - | - | F 54 | 180 | 174 | 154 |
| 62 | - | - | F 55 | 184 | 177 | 162 |
| 63 | - | - | F 56 | 188 | 176 | 150 |
| 64 | - | - | F 57 | 192 | 187 | 173 |
| 65 | - | - | F 58 | 198 | 180 | 150 |
| 66 | - | - | F 59 | 200 | 193 | 180 |
| | | | F 60 | 205 | 189 | 160 |
| | | | F 61 | 212 | 200 | 162 |
| | | | F 62 | 226 | 214 | 190 |
| | | | F 63 | 230 | 222 | 200 |
| | | | F 64 | 240 | 224 | 192 |
| | | | F 65 | 250 | 228 | 200 |
| | | | F 66 | 256 | 240 | 220 |
| | | | F 67 | 265 | 240 | 213 |
| | | | F 68 | 275 | 253 | 225 |
| | | | F 69 | 286 | 277 | 242 |
| | | | F 70 | 296 | 287 | 260 |
| | | | F 71 | 300 | 280 | 252 |
| | | | F 72 | 325 | 305 | 278 |
| | | | F 73 | 350 | 330 | 302 |
| | | | F 74 | 375 | 355 | 328 |
| | | | F 75 | 405 | 380 | 354 |
| | | | F 76 | 430 | 406 | 380 |
| | | | F 77 | 455 | 432 | 405 |
| | | | F 78 | 480 | 457 | 430 |
| | | | F 79 | 530 | 508 | 481 |
| | | | F 80 | 595 | 572 | 544 |
| | | | F 81 | 184 | 168 | 135 |